

EZ SERIES Pluggger Panel

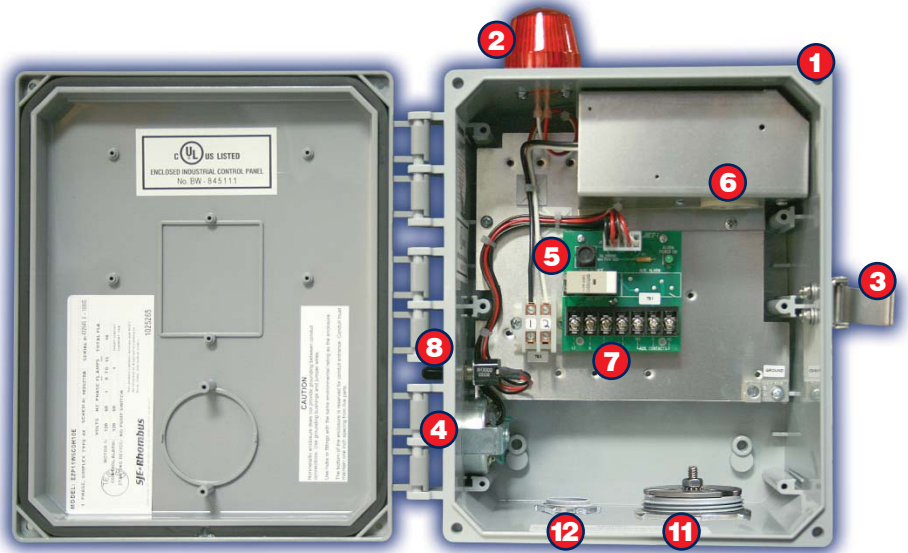

Easy Installations with EZ Series® Panels from SJE-Rhombus®!

The **NEW EZ Series® Pluggger** panel provides a convenient wiring connection for use with one single phase pump in effluent and sewage installations. The **EZ Series® Pluggger** panel features a **built-in high water alarm** and a **receptacle** to accept a 120V or 230V pump and a piggy-back pump switch. The **convenient mounting post** (optional) features a **removable access door** to allow for **easier wiring**. **EZ Series® Pluggger** panel is **UL/cUL Listed** and backed by a **three-year limited warranty**.

EZ Series® Pluggger Features:

- 1 NEMA 4X enclosure with hinged cover for indoor/outdoor use
- 2 Red alarm beacon
- 3 **Locking latch** (standard) for added safety
- 4 Audible alarm
- 5 Alarm fuse
- 6 **Receptacle** for pump and pump switch (120V or 230V)
- 7 Terminal strip for easy wiring
- 8 External test/normal/silence switch with automatic alarm reset for easy operation

Optional Post Features:

- 9 Post can be mounted directly into ground, over a 4x4, or conduit for **quick, clean, easy installation**
- 10 Post features removable access door for easy wiring
- 11 Custom engineered liquid-tight 2" cable seal
- 12 Incoming pump power 3/4" hub

Available Options:

Elapsed time meter, duo alarms and **auxiliary contacts** available for local **code compliance**

SJE-Rhombus®

1-888-DIAL-SJE (342-5753) ■ Fax: 218-847-4617

www.sjerrhombus.com

Optional mounting post shown here.

©SJE-Rhombus 02/10

EZ SERIES Simplex Panel

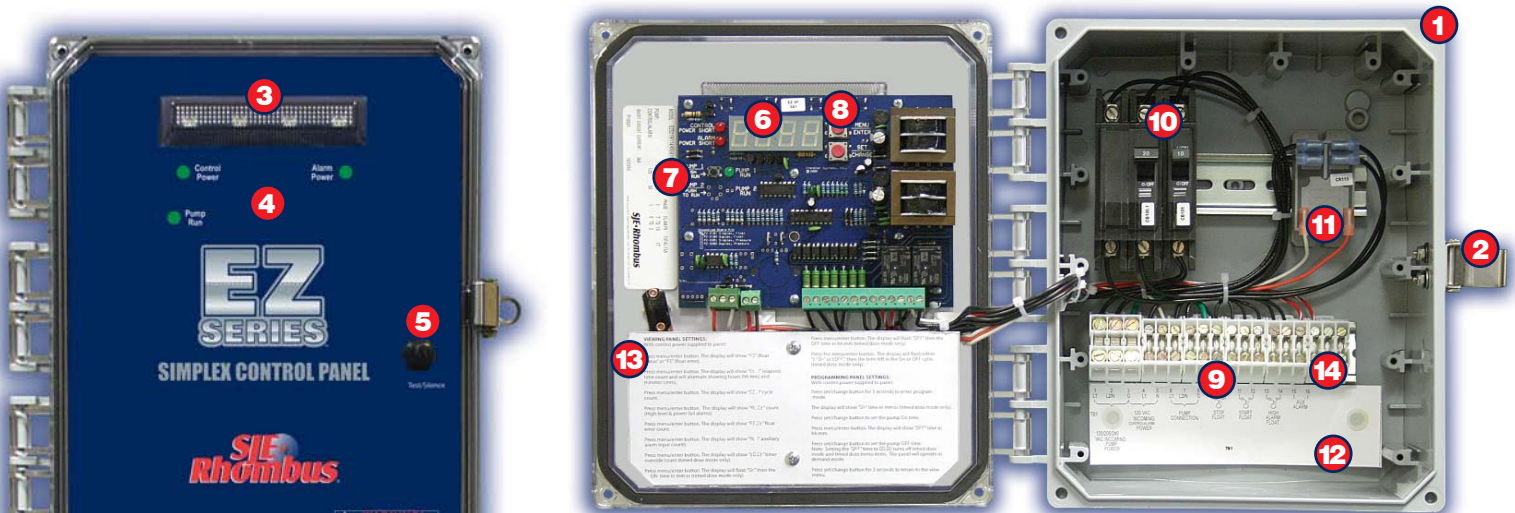

Easy Installations with EZ Series® Panels from SJE-Rhombus®!

The **NEW EZ Series® Single Phase Simplex** panel is designed to control one 120/208/240V single phase pump in water and sewage installations. It features a **digital display** on the inside of the front cover for programming pump control and system monitoring. This innovative control panel is **easily converted** to demand or timed dose **in the field**. **EZ Series® Simplex** panel is **UL/cUL Listed** and backed by a **three-year** limited warranty. **Duplex model available!**

EZ Series® Simplex Features:

- 1** **NEMA 4X enclosure** with hinged cover for indoor/outdoor use
- 2** **Locking latch** (standard) for added safety
- 3** Flashing red **alarm beacon** on cover; audible alarm horn
- 4** **External indicators** for control power, alarm power and pump run
- 5** **External test/silence switch** for easy operation
- 6** **Digital display** features:
 - Float status
 - Elapsed time pump run
 - Cycle counter
 - Alarm counts (high water/power fail)
 - Float error count
 - Auxiliary alarm counter
 - Timer override count (TD only)
 - On time (TD only)
 - Off time (TD only)
- 7** **Pump Run** button
- 8** **Menu/Enter & Set/Change** buttons for programming and viewing control panel
- 9** **Large terminal strip** for easy wiring
- 10** **Two circuit breakers:** one for pump power; another for control and alarm power
- 11** **Pump run relay** (30 amp) controls pump by switching electrical lines
- 12** **Field wiring diagram**
- 13** Easy-to-follow **programming and operation label**
- 14** Auxiliary alarm contacts (standard)

Optional Post Features:

- 15** Post can be mounted directly into ground, over a 4x4, or conduit for **quick, clean, easy installation**
- 16** Post features **removable access door** for easy wiring

Available Options:

Duo alarms for local code compliance



1-888-DIAL-SJE (342-5753)
www.sjerrhombus.com

©SJE-Rhombus 02/10



Optional mounting post shown here.